



**SOP SERIES**



## SELF-SUCKING PUMPS

### SOP SERIES

#### INSTALLATION AND APPLICATIONS

These pumps are suitable for handling clean water not containing abrasive particles and fluids which are not chemically aggressive to the pump components. reliable, compact, economic and simple to use. They are particular suitable for domestic and industrial applications such as water supply for recirculation in air conditioners and refrigerators, industrial water uses in general, and the automatic distribution of water from surge tanks, watering gardens, lifting water from tanks or wells down to 9m depth. These pumps should be installed in a covered area, protected against the weather.

#### OPERATING LIMITS

Suction lift up to 9 m  
 Fluid temperature up to + 60°C  
 Maximum ambient temperature +40°C

#### STRUCTURAL CHARACTERISTICS

<b>PUMP BODY</b>	Cast iron
<b>FRONT COVER</b>	Cast iron
<b>IMPELLER</b>	Brass , with radial peripheral blades, floating on the shaft.
<b>MECHANICAL SEAL</b>	Ceramic and graphite

#### MOTOR:

The pumps are coupled directly to an asynchronous, high efficiency silver elephant induction motor of suitable size, which is quiet running, close and extremely ventilated, with 1M B3 structural shape, suitable for continuous duty. INSULATION class For B.

**The thermal cutout relay (motor protector) is incorporated in single phase motors.**

Three phase motors require an adequate external motor protector, with connections according to current standards.

**INSULATION** Class B

**PROTECTION** IP44

**CONSTRUCTION AND SAFETY STANDARDS** in compliance with IEC.

#### PERFORMANCE

The wide range of pumps in the SOP series satisfies the most operating requirements with features such as:

- high heads with respect to power requirements;
- Stable operating curves, with small variations in delivery rates with respect to large variations in the pressure demand;
- high tolerance of the presence of entrained air in the fluid being pumped;
- suction capacity up to 9 meters.

#### PERFORMANCE RANGE

Flow rate up to 55 l/min (3.3 m<sup>3</sup>/h)  
 Dynamic head up to 35m

#### WARRANTY: 1 YEARS

(according to our general sales conditions).

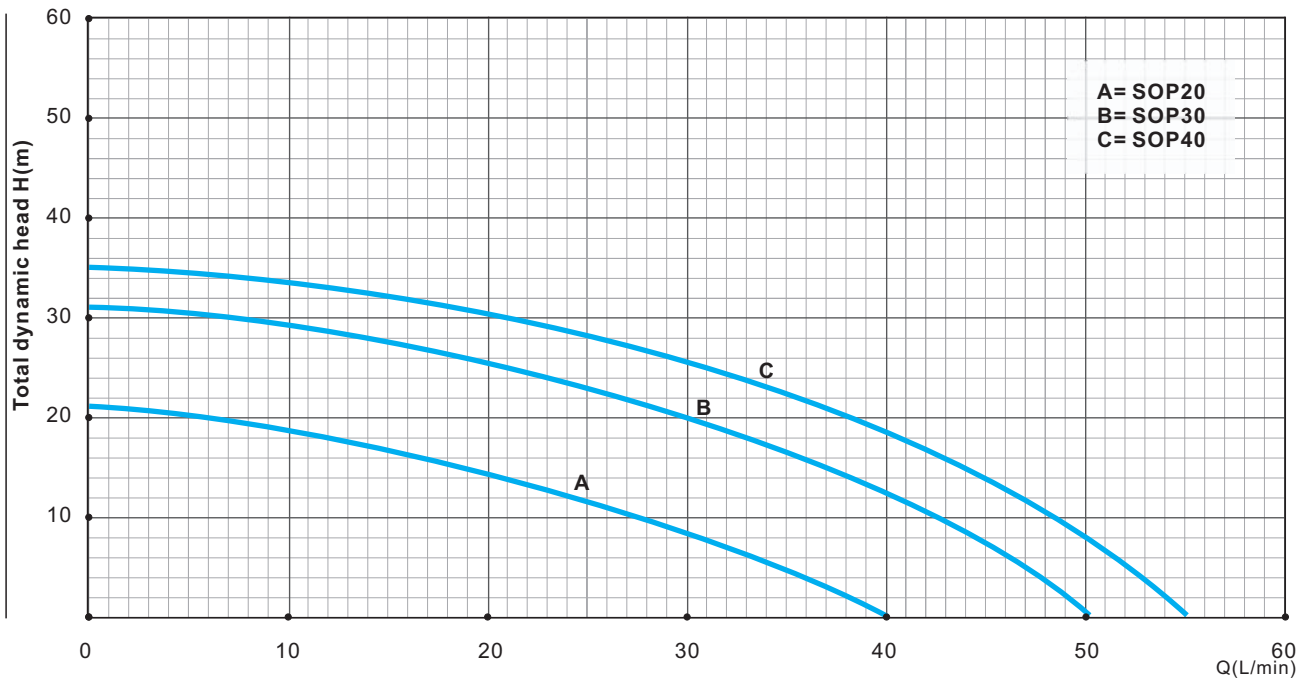

**TECHNICAL DATA**

Type	Power HP	Power kW	Ampere 1~220	R.P.M	Q.Max (l/min)	H.Max (m)	S.Head (M)	Pipe Dia	L×W×H (mm)	N.W (Kg)
SOP20	0.5	0.37	2.4	2850	40	21	9	1"X1"	300X180X200	7.9
SOP30	0.75	0.55	3.6	2850	50	31	9	1"X1"	300X180X200	10.7
SOP40	1	0.75	4.8	2850	55	35	9	1"X1"	300X180X200	12.1

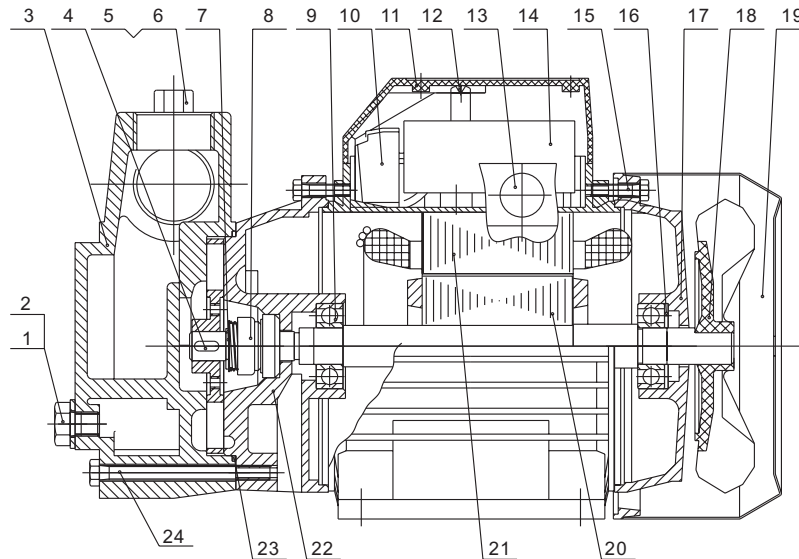

**MATERIAL DATA**

Item	Description.	Material	Item	Description.	Material	Item	Description.	Material	Item	Description.	Material	Item	Description.	Material
1	Plug	H59	6	Priming Plug	Brass H59	11	Terminal cover	ABS	16	Spring ring	ABS	21	Stator	
2	Washer	NBR	7	Snap ring	SS420	12	Screw	Steel-A3	17	End cover	Steel-A3	22	Front cover	C.I.-HT200
3	Pump Body	C.I.-HT200	8	M. Seal	SS304&NBR...	13	Fairlead	NBR	18	Fan	NBR	23	O ring	NBR
4	Key	SS420	9	Bearing		14	Capacitor	CBB60	19	Fan Cover	CBB60	24	Impeller	Brass H59
5	Washer	NBR	10	Terminal block	ABS	15	Screw	Steel-A3	20	Rotor	Steel-A3	25	screw	A3