



## PERIPHERAL PUMPS

### QB SERIES

#### INSTALLATION AND APPLICATIONS

These pumps are suitable for handling clean water not containing abrasive particles and fluids which are not chemically aggressive to the pump components.

They are extremely reliable, light, economic and simple to use, finding many uses in domestic applications, in particular the automatic distribution of water from surge tanks, watering gardens and for boosting insufficient mains water pressure.

These pumps should be installed in a covered area, protected against the weather.

#### OPERATING LIMITS

Suction lift up to 9 m

Fluid temperature up to + 60°C

Maximum ambient temperature +40°C

#### PERFORMANCE

The wide range of pumps in the QB series satisfies the most various operating requirements with features such as: high heads with respect to power requirements.

Stable operating curves, with small variations in delivery rates with respect to large variations in the pressure demand. high tolerance of the presence of entrained air in the fluid to the pumped.

Suction capacity up to 9 meters.

#### PERFORMANCE RANGE

Flow rate up to 60 l/min (3.6m<sup>3</sup>/h)

Dynamic head up to 75m

#### WARRANTY: 1 YEARS

(according to our general sales conditions).

#### STRUCTURAL CHARACTERISTICS

<b>PUMP BODY</b>	Cast iron
<b>FRONT COVER</b>	Cast iron or aluminium with bronze
<b>IMPELLER</b>	Brass , with radial peripheral blades, floating on the shaft.
<b>MECHANICAL SEAL</b>	Ceramic and graphite

#### MOTOR:

The pumps are coupled directly to an asynchronous, high efficiency SILVER ELEPHANT induction motor of suitable size, which is quiet running, close and extremely ventilated, with 1m b3 structural shape, suitable for continuous duty. Insulation class for B.

**The thermal cutout relay (motor protector) is incorporated in single phase motors.**

Three phase motors require an adequate external motor protector, with connections according to current standards.

**INSULATION** Class B

**PROTECTION** IP44

**CONSTRUCTION AND SAFETY STANDARDS** in compliance with IEC.

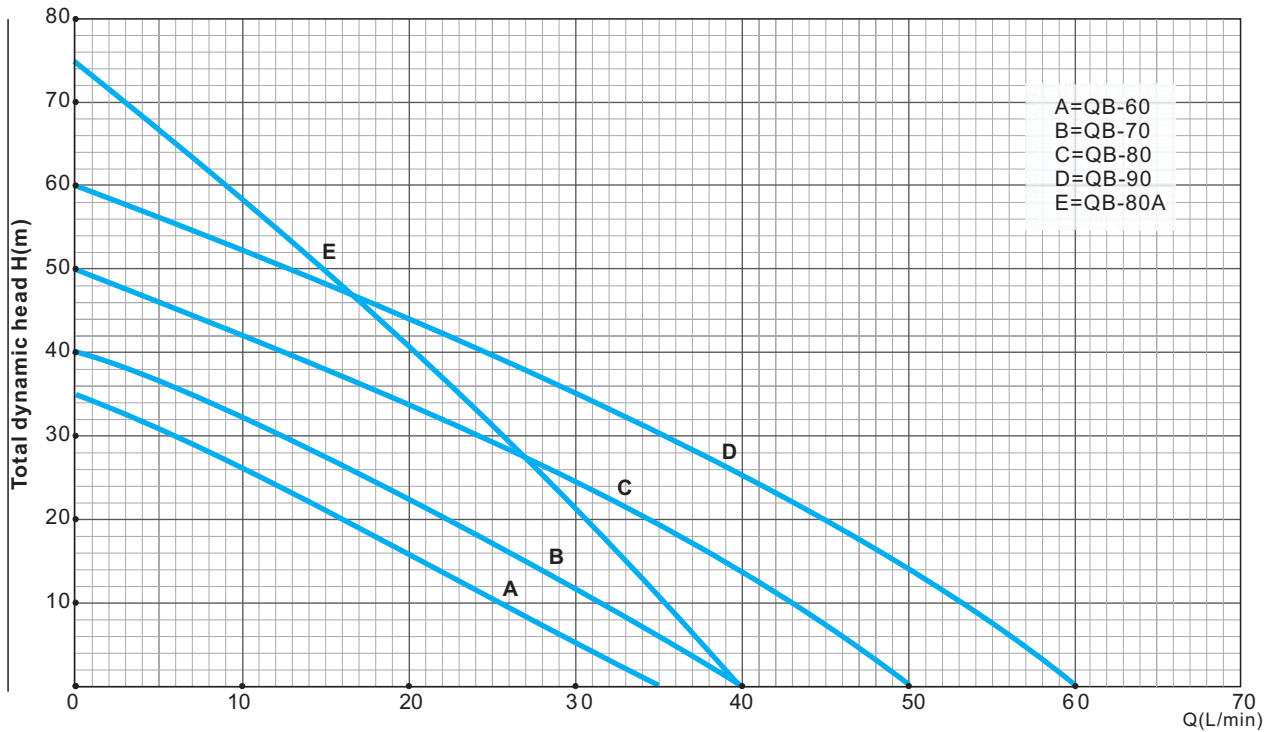

**TECHNICAL DATA**

Type	Power		Ampere 1~220V	R.P.M	Q.Max (l/min)	H.Max (m)	S.Head (M)	Pipe Dia	L×W×H (mm)	N.W (Kg)
	HP	kW								
QB-60	0.5	0.37	1.6	2850	35	35	9	1"X1"	280X145X180	5.8
QB-70	0.75	0.55	3.6	2850	40	40	9	1"X1"	310X180X200	9.7
QB-80	1.0	0.75	4.8	2850	50	50	9	1½"X1½"	310X180X200	10.5
QB-90	1.5	1.1	6.2	2850	60	60	9	1½"X1½"	415X195X220	17
QB-80A	1.0	0.75	4.8	2850	40	75	9	1"X1"	310X180X200	10.5

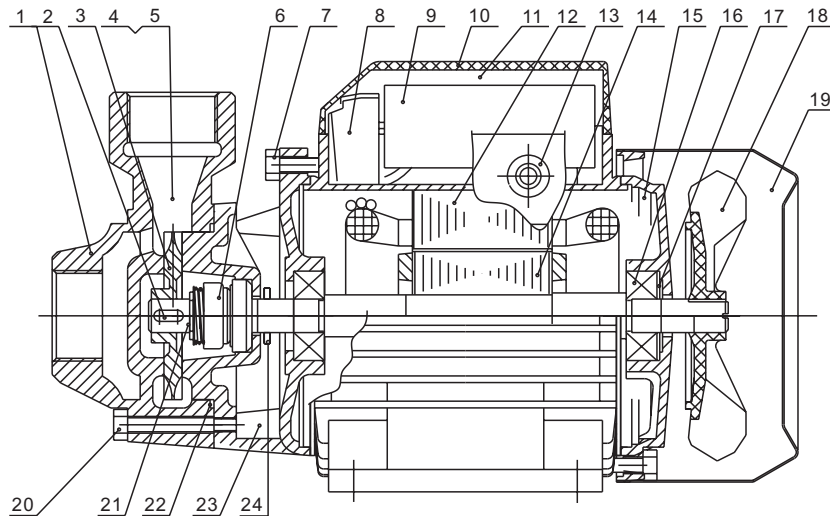

**MATERIAL DATA**

Item	Description	Material	Item	Description	Material	Item	Description	Material	Item	Description	Material	Item	Description	Material
1	Pump Body	C.I.-HT200	6	M. Seal	SS304&NBR	11	Screw	Steel-A3	16	Bearing		21	Snap ring	SS420
2	Key	SS420	7	Screw	Steel-A3	12	Stator		17	Spring ring	65Mn	22	O ring	NBR
3	Impeller	Brass H59	8	Terminal Block	ABS	13	Fairlead	NBR	18	Fan	ABS	23	Front Cover	C.I.HT200
4	Priming Plug	Brass H59	9	Capacitor	CBB60	14	Rotor		19	Fan Cover	A3	24	Drops guard	NBR
5	Washer	NBR	10	Terminal Cover	ABS	15	End Cover	AL-ZL102	20	Screw	A3	25		