



SELF-PRIMING JET PUMPS

JET-L SERIES

INSTALLATION AND APPLICATIONS

These pumps are suitable for pumping clean water and fluids which are not chemically aggressive to pump components. They are extremely reliable, economical and simple to use, being particularly suitable for domestic applications such as the automatic distribution of water from small and medium-size tanks, watering gardens, etc. These pumps should be installed in a covered area, protected against the weather.

OPERATING LIMITS

Suction lift up to 9 m
 Fluid temperature up to + 50°C
 Maximum ambient temperature +40°C

PERFORMANCE

The wide range of pump in the JET-L series satisfied the most varied requirements with features such as:

- high heads with respect to power required.
- flat operating and power absorption curves, giving moderate curve variations with respect to large variations in delivery demand.
- high tolerance of the presence of entrained air in the fluid to be pumped.
- suction capacity up to 9 meters

PERFORMANCE RANGE

Flow rate up to 100 l/min (6.0m³/h)
 Dynamic head up to 65m

WARRANTY: 1 YEARS

(according to our general sales conditions).

STRUCTURAL CHARACTERISTICS

| | |
|------------------------|---|
| PUMP BODY | Cast iron |
| FRONT COVER | Cast iron |
| EJECTOR UNIT | Techno Polymer (approved For Drinking Water) |
| IMPELLER | Centrifugal Radial Flow In Brass Or Technopolymer (approved For Drinking Water) on Request. |
| MECHANICAL SEAL | Ceramic and graphite |

MOTOR:

The Pumps Are Coupled Directly To An Asynchronous, High Efficient SILVER ELEPHANT Induction Motor Of Suitable Size, which Is Quiet Running, Closed And Extremely Ventilated, Suitable For Continuous Duty. Insulation Class B.

The thermal cutout relay (motor protector) is incorporated in single phase motors.

Three phase motors require an adequate external motor protector, with connections according to current standards.

INSULATION Class B

PROTECTION IP44

CONSTRUCTION AND SAFETY STANDARDS in compliance with IEC.

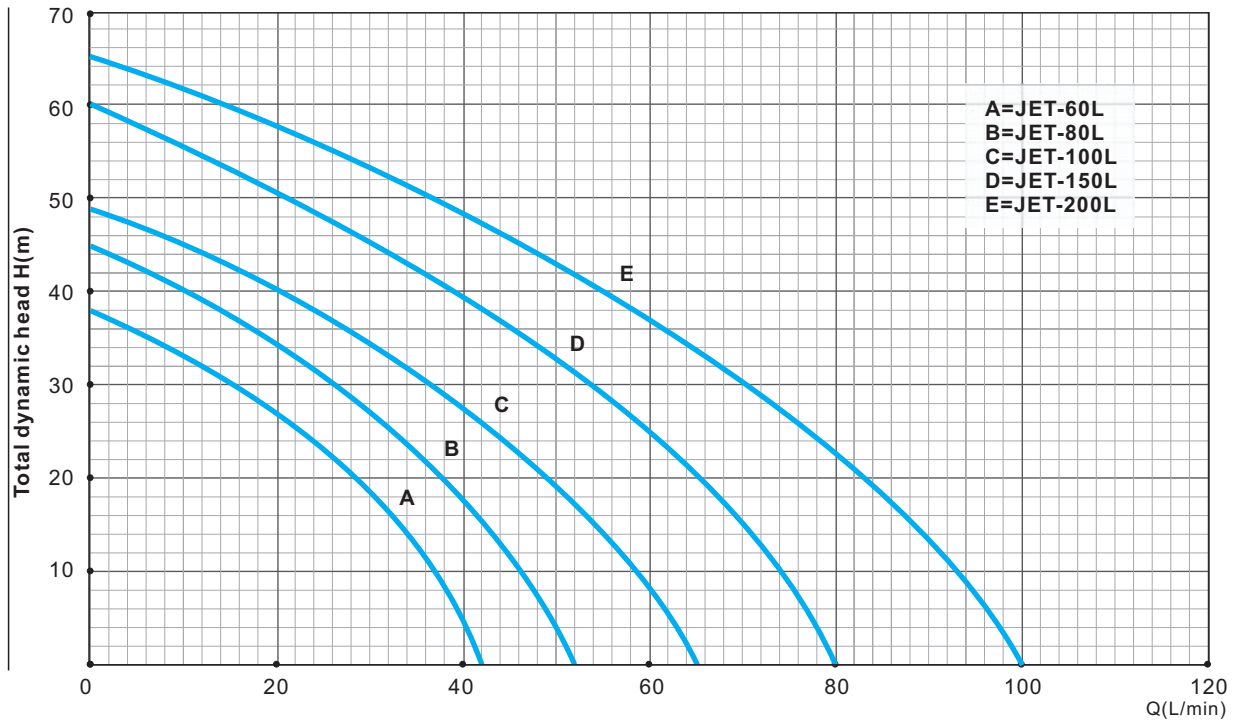

TECHNICAL DATA

| Type | Power HP | Power kW | Ampere 1~220V | R.P.M | Q.Max (l/min) | H.Max (m) | S.Head (M) | Pipe Dia | L×W×H (mm) | N.W (Kg) |
|----------|-------------|-------------|------------------|-------|------------------|--------------|---------------|----------|---------------|-------------|
| JET-60L | 0.5 | 0.37 | 3.0 | 2850 | 42 | 38 | 9 | 1"X1" | 480X210X220 | 15.3 |
| JET-80L | 0.75 | 0.55 | 3.6 | 2850 | 52 | 45 | 9 | 1"X1" | 480X210X220 | 15.7 |
| JET-100L | 1 | 0.75 | 4.8 | 2850 | 65 | 49 | 9 | 1"X1" | 480X210X220 | 16.9 |
| JET-150L | 1.5 | 1.1 | 6.0 | 2850 | 80 | 60 | 9 | 1¼"X1" | 530X240X260 | 24.5 |
| JET-200L | 2.0 | 1.5 | 8.2 | 2850 | 100 | 65 | 9 | 1¼"X1" | 530X240X260 | 26.0 |

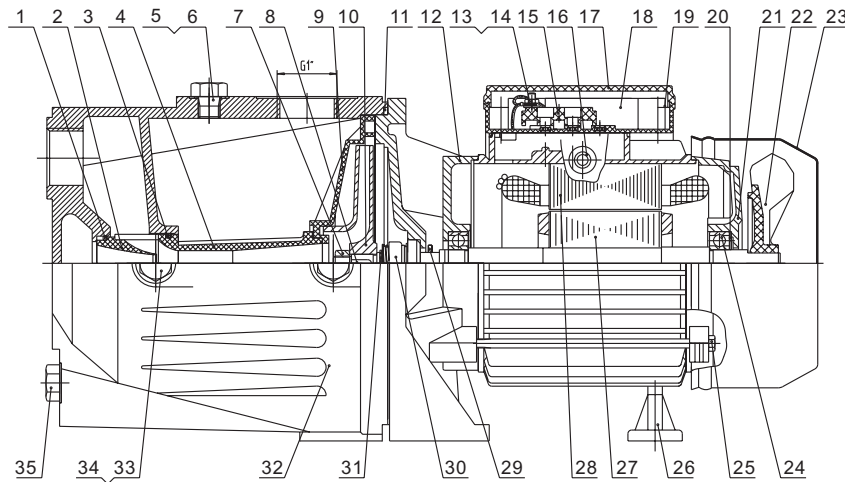

MATERIAL DATA

| Item | Description. | Material | Item | Description. | Material | Item | Description. | Material | Item | Description. | Material | Item | Description. | Material |
|------|--------------|-----------|------|----------------|------------|------|----------------|-----------|------|--------------|----------|------|--------------|------------|
| 1 | O ring | NBR | 8 | Key | SS420 | 15 | Terminal block | ABS | 22 | Fan | ABS | 29 | Drops guard | NBR |
| 2 | Nozzle | Noryl | 9 | Diffuser | Noryl | 16 | Fairlead | NBR | 23 | Fan cover | A3 | 30 | M. Seal | SS304&NBR |
| 3 | O ring | NBR | 10 | Impeller | Noryl | 17 | Terminal box | ABS | 24 | Bearing | | 31 | Snap ring | SS420 |
| 4 | Venturi tube | Noryl | 11 | O ring | NBR | 18 | Capacitor | CBB60 | 25 | Screw | Steel-A3 | 32 | Pump body | C.I.-HT200 |
| 5 | Priming plug | Brass H59 | 12 | Front cover | C.I.-HT200 | 19 | Screw | Steel-A3 | 26 | Foot | | 33 | Washer | NBR |
| 6 | Washer | NBR | 13 | Terminal cover | ABS | 20 | Spring ring | 65Mn | 27 | Rotor | | 34 | Switch plug | Brass H59 |
| 7 | Nut | 45# | 14 | Washer | T2 | 21 | End cover | C.I.HT200 | 28 | Stator | | 35 | Drain plug | H59 |