

PERIPHERAL PUMP

IDB SERIES

INSTALLATION AND APPLICATIONS

These pumps are suitable for handling clean water not containing abrasive particles and fluids which are not chemically aggressive to the pump components.

They are extremely reliable, light, economic and simple to use, finding many uses in domestic applications, in particular the automatic distribution of water from surge tanks, watering gardens and for boosting insufficient mains water pressure.

These pumps should be installed in a covered area, protected against the weather.

OPERATING LIMITS

Suction lift up to 9 m

Fluid temperature up to + 60°C

Maximum ambient temperature +40°C

PERFORMANCE

The wide range of pumps in the IDB series satisfies the most various operating requirements with features such as: high heads with respect to power requirements.

Stable operating curves, with small variations in delivery rates with respect to large variations in the pressure demand. high tolerance of the presence of entrained air in the fluid to the pumped.

Suction capacity up to 9 meters.

PERFORMANCE RANGE

Flow rate up to 60 l/min (3.6 m³/h)

Dynamic head up to 60m

WARRANTY: 1 YEARS

(according to our general sales conditions).

STRUCTURAL CHARACTERISTICS

PUMP BODY	Cast iron
FRONT COVER	Cast iron
IMPELLER	Brass , with radial peripheral blades, floating on the shaft.
MECHANICAL SEAL	Ceramic and graphite

MOTOR:

The pumps are coupled directly to an asynchronous, high efficiency SILVER ELEPHANT induction motor of suitable size, which is quiet running, close and extremely ventilated, with 1m b3 structural shape, suitable for continuous duty. Insulation class for b.

The thermal cutout relay (motor protector) is incorporated in single phase motors.

Three phase motors require an adequate external motor protector, with connections according to current standards.

INSULATION Class B

PROTECTION IP44

CONSTRUCTION AND SAFETY STANDARDS in compliance with IEC.

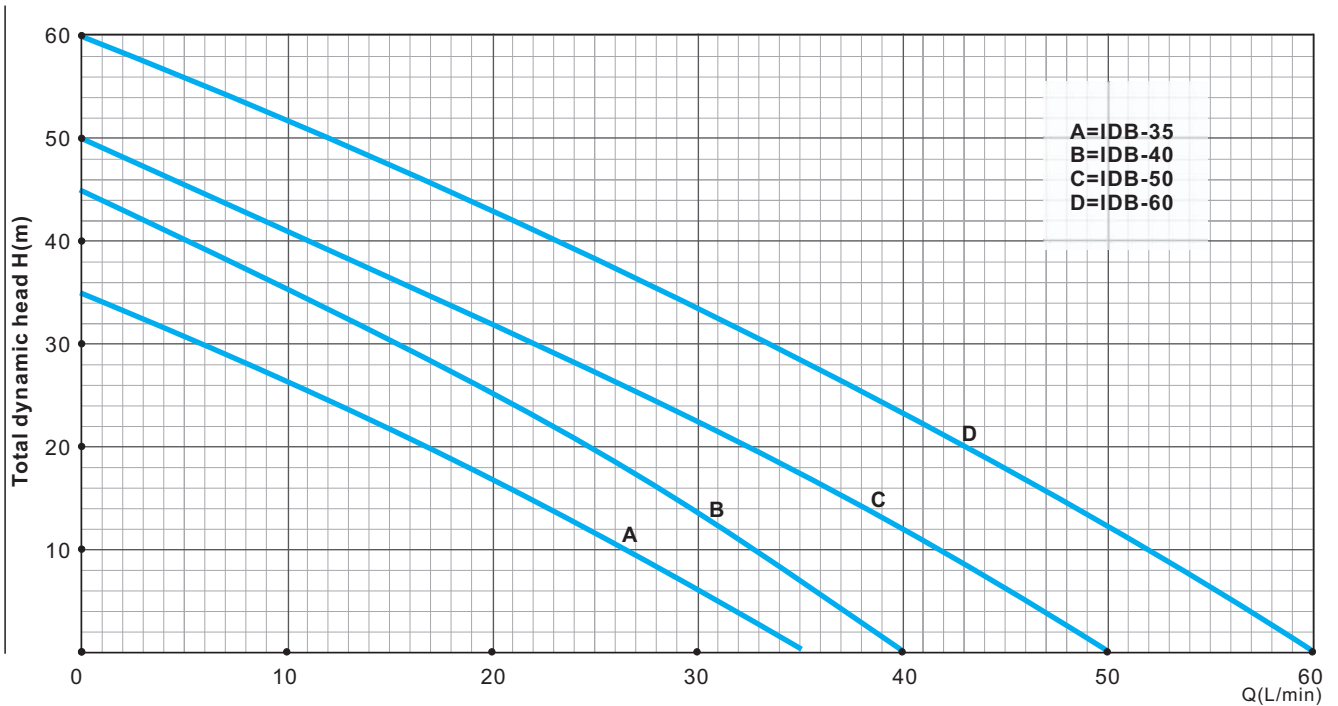

TECHNICAL DATA

Type	Power HP kW	Ampere 1~220V	R.P.M	Q.Max (l/min)	H.Max (m)	S.Head (M)	Pipe Dia	L×W×H (mm)	N.W (Kg)
IDB-35	0.5 0.37	1.6	2850	35	35	9	1"X1"	290X170X180	5.9
IDB-40	0.75 0.55	3.6	2850	40	45	9	1"X1"	330X185X205	9.7
IDB-50	1 0.75	4.8	2850	50	50	9	1½"X1½"	330X185X205	10.4
IDB-60	1.5 1.1	6.2	2850	60	60	9	1½"X1½"	425X220X255	17.2

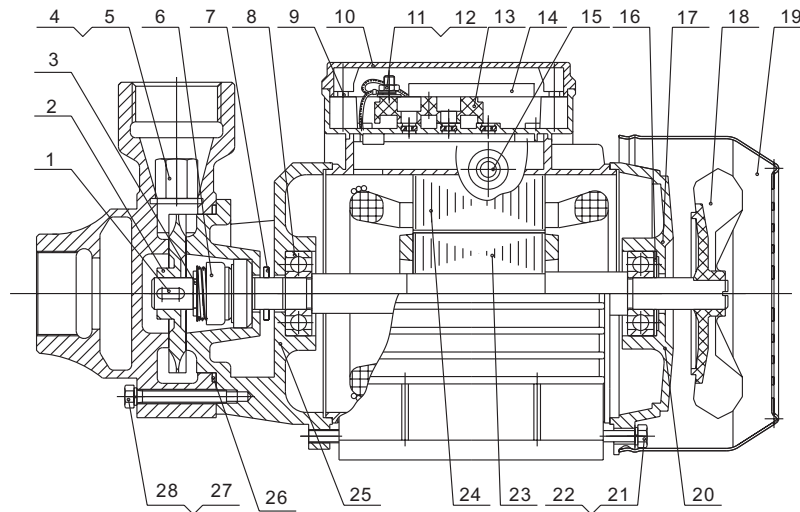

MATERIAL DATA

Item	Description.	Material	Item	Description.	Material	Item	Description.	Material	Item	Description.	Material	Item	Description.	Material
1	Key	SS420	7	Drop guard	NBR	13	Terminal block	ABS	19	Fan cover	A3	25	Front cover	C.I.-HT200
2	Impeller	Brass H59	8	Bearing		14	Capacitor	CBB60	20	Bearing		26	O ring	NBR
3	Snap ring	SS420	9	Screw	Steel-A3	15	Fairlead	NBR	21	Screw	A3	27	Screw	Steel-A3
4	Priming Plug	Brass H59	10	Terminal box	ABS	16	Spring ring	65Mn	22	Washer	A3	28	Pump Body	C.I.-HT200
5	Washer	NBR	11	Nut	H59	17	End cover	HT200	23	Rotor				
6	M. Seal	SS304&NB	12	Washer	T2	18	Fan	ABS	24	Stator				