



CENTRIFUGAL PUMPS

FCP SERIES

INSTALLATION AND APPLICATIONS

These pumps are suitable for pumping clean water and fluids which are not chemically aggressive to the pump components. They are extremely reliable, simple to use, quiet and virtually maintenance-free, finding many uses in domestic and civil applications, and in particular the automatic distribution of water from small and medium-size surge tanks, transfer water, watering gardens, etc.

These pumps should be installed in a covered area, protected against the weather.

OPERATING LIMITS

Suction lift up to 7 m
 Fluid temperature up to + 80°C
 Maximum ambient temperature +40°C

PERFORMANCE

The range of pumps making up the FCP series is particularly varied: however when developing the single units, care was taken to aim at standardizing the following features within the series:
 Ample and stable characteristic curves
 -Outputs having good absolute values and tendentially flat curves:
 -Flat absorption curves at high delivery rates, preventing motor overloading even during prolonged use:
 -Good suction capacities both at low and high delivery rates

PERFORMANCE RANGE

Flow rate up to 330 l/min (19.8 m³/h)
 Dynamic head up to 18m

WARRANTY: 1 YEARS

(according to our general sales conditions).

STRUCTURAL CHARACTERISTICS

PUMP BODY	Aluminum
FRONT COVER	Aluminum
PUMP BODY COVER	ABS or Technopolymer
IMPELLER	Brass, centrifugal radial flow type (technopolymer impeller on request)
MECHANICAL SEAL	Ceramic and graphite

MOTOR:

The pumps are coupled directly to an asynchronous, high efficiency SILVER ELEPHANT induction motor of suitable size, which is quiet running, close and extremely ventilated, suitable for continuous duty.

The thermal cutout relay (motor protector) is incorporated in single phase motors.

Three phase motors require an adequate external motor protector, with connections according to current standards.

INSULATION Class B

PROTECTION IP44

CONSTRUCTION AND SAFETY STANDARDS in compliance with IEC.

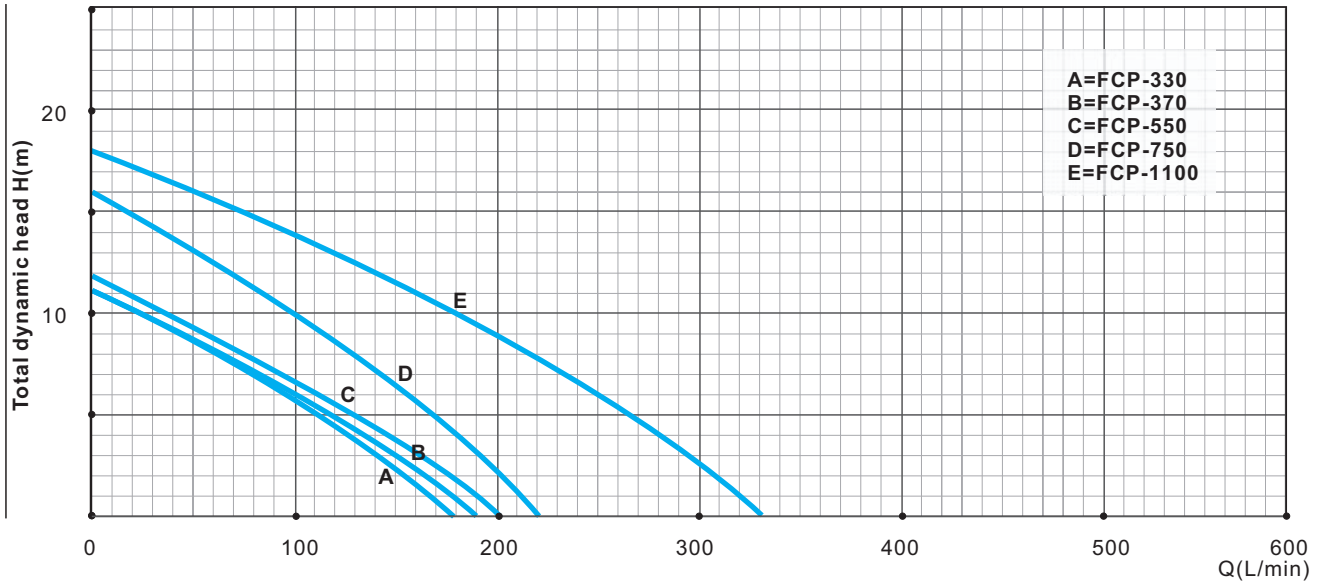

TECHNICAL DATA

Type	Power		Ampere 1~220V	R.P.M	Q.Max (l/min)	H.Max (m)	S.Head (M)	Pipe Dia	L×W×H (mm)	N.W (Kg)
	HP	kW								
FCP-330	0.45	0.33	2.2	2850	180	11	7	1½"X 1½"	470X180X260	5.5
FCP-370	0.5	0.37	2.7	2850	190	12	7	1½"X 1½"	495X180X260	6.0
FCP-550	0.75	0.55	3.6	2850	200	14	7	1½"X 1½"	495X180X260	8.5
FCP-750	1	0.75	4.5	2850	220	16	7	1½"X 1½"	495X180X260	9.5
FCP-1100	1.5	1.1	7.5	2850	330	18	7	2"X1.5"	530X180X260	15

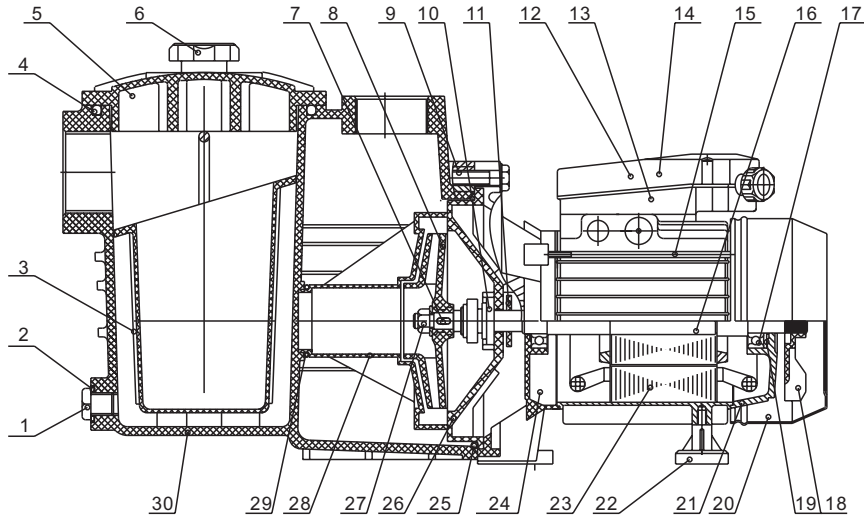

MATERIAL DATA

Item	Description.	Material	Item	Description.	Material	Item	Description.	Material	Item	Description.	Material	Item	Description.	Material
1	Plug	Brass H59	7	Key	SS420	13	Terminal block	ABS	19	Spring ring	65Mn	25	O ring	NBR
2	Washer	NBR	8	Impeller	Brass H59	14	Capacitor	CBB60	20	Fan cover	A3	26	Cover	ABS
3	Filter	ABS	9	Screw	A3	15	Screw	Steel-A3	21	End cover	AL-ZL102	27	Nut	H59
4	O ring	NBR	10	M. Seal	SS304&NBR	16	Rotor		22	Foot		28	Diffuser	ABS
5	Cover	Plastic	11	Drops guard	NBR	17	Bearing		23	Stator		29	O ring	NBR
6	Screw		12	Terminal cover	ABS	18	Fan	ABS	24	Front cover	AL-ZL102	30	Pump Body	ABS