



CENTRIFUGAL PUMPS

DK SERIES

INSTALLATION AND APPLICATIONS

These pumps are suitable for pumping clean water and fluids which are not chemically aggressive to the pump components. They are extremely reliable, simple to use, quiet and virtually maintenance-free, finding many uses in domestic and civil applications, and in particular the automatic distribution of water from small and medium-size surge tanks, transfer water, watering gardens, etc.

These pumps should be installed in a covered area, protected against the weather.

OPERATING LIMITS

Suction lift up to 7 m

Fluid temperature up to + 80°C

Maximum ambient temperature +40°C

PERFORMANCE

The range of pumps making up the DK series is particularly varied: however when developing the single units, care was taken to aim at standardizing the following features within the series:

Ample and stable characteristic curves

-Outputs having good absolute values and tendentially flat curves:

-Flat absorption curves at high delivery rates, preventing motor overloading even during prolonged use:

-Good suction capacities both at low and high delivery rates

-Non jam impeller for pumping dirty or sandy water

PERFORMANCE RANGE

Flow rate up to 340 l/min (20.4 m³/h)

Dynamic head up to 20m

WARRANTY: 1 YEARS

(according to our general sales conditions).

STRUCTURAL CHARACTERISTICS

PUMP BODY	Cast iron
FRONT COVER	Cast iron
IMPELLER	Brass or cast iron
MECHANICAL SEAL	Ceramic and graphite

MOTOR:

The pumps are coupled directly to an asynchronous, high efficiency SILVER ELEPHANT induction motor of suitable size, which is quiet running, close and extremely ventilated, suitable for continuous duty.

The thermal cutout relay (motor protector) is incorporated in single phase motors.

Three phase motors require an adequate external motor protector, with connections according to current standards.

INSULATION Class B

PROTECTION IP44

CONSTRUCTION AND SAFETY STANDARDS in compliance with IEC.

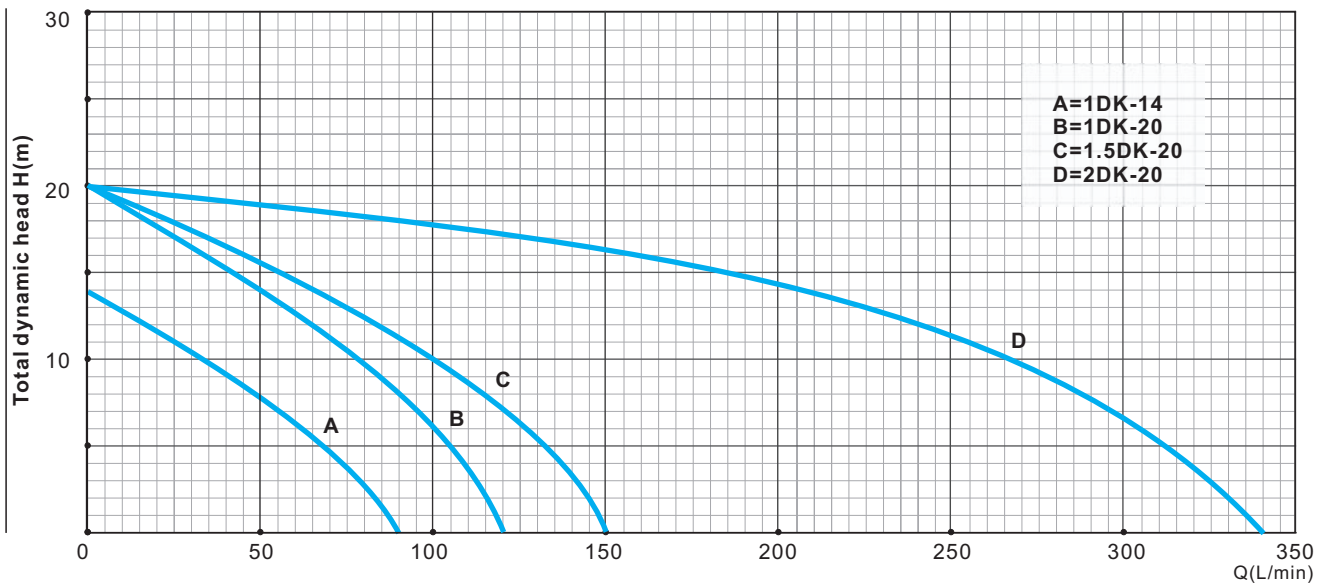

TECHNICAL DATA

Type	Power HP	Power kW	Ampere 1~220V	R.P.M	Q.Max (l/min)	H.Max (m)	S.Head (M)	Pipe Dia	L×W×H (mm)	N.W (Kg)
1DK-14	0.45	0.33	2.5	2850	90	14	7	1"X1"	290X165X190	2.8
1DK-20	0.75	0.55	3.6	2850	120	20	7	1"X1"	310X190X210	8.7
1.5DK-20	1	0.75	4.8	2850	150	20	7	1 1/2"X1 1/2"	310X190X210	13
2DK-20	2	1.5	9.6	2850	340	20	7	2"X2"	394X243X265	24.5

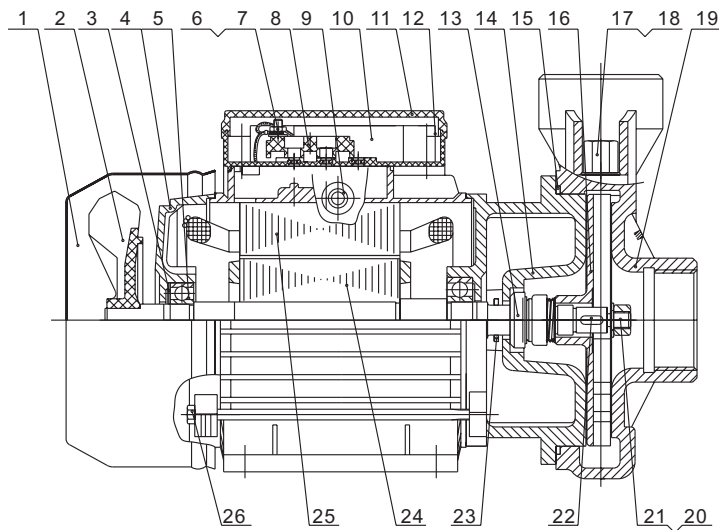

MATERIAL DATA

Item	Description.	Material	Item	Description.	Material	Item	Description.	Material	Item	Description.	Material	Item	Description.	Material
1	Fan cover	A3	7	Screw	A3	13	M.Seal	SS304&NBR...	19	Pump Body	C.I.-HT200	25	Stator	
2	Fan	ABS	8	Terminal block	ABS	14	Front cover	C.I.-HT200	20	Washer	65Mn	26	Screw	A3
3	Spring ring	65Mn	9	Fairlead	NBR	15	O ring	NBR	21	Screw	Steel-A3			
4	End cover	AL-ZL102	10	Capacitor	CBB60	16	Impeller	Brass H59	22	Key	SS420			
5	Bearing		11	Terminal cover	ABS	17	Washer	NBR	23	Drops guard	NBR			
6	Washer	T2	12	Screw	Steel-A3	18	Priming Plug	Brass H59	24	Rotor				