



## CENTRIFUGAL PUMPS

### CPM SERIES

#### INSTALLATION AND APPLICATIONS

These pumps are suitable for pumping clean water and fluids which are not chemically aggressive to the pump components. They are extremely reliable, simple to use, quiet and virtually maintenance-free, finding many uses in domestic and civil applications, and in particular the automatic distribution of water from small and medium-size surge tanks, transfer water, watering gardens, etc.

These pumps should be installed in a covered area protected against the weather.

#### OPERATING LIMITS

Suction lift up to 7 m

Fluid temperature up to + 80°C

Maximum ambient temperature +40°C

#### PERFORMANCE

The range of pumps making up the CPM series is particularly varied: however when developing the single units, care was taken to aim at standardizing the following features within the series:

Ample and stable characteristic curves

-Outputs having good absolute values and tendentially flat curves:

-Flat absorption curves at high delivery rates, preventing motor

overloading even during prolonged use:

-Good suction capacities both at low and high delivery rates

#### PERFORMANCE RANGE

Flow rate up to 140 l/min (8.4m<sup>3</sup>/h)

Dynamic head up to 44m

#### WARRANTY: 1 YEARS

(according to our general sales conditions).

#### STRUCTURAL CHARACTERISTICS

<b>PUMP BODY</b>	Cast iron
<b>FRONT COVER</b>	Cast iron
<b>IMPELLER</b>	Brass , centrifugal radial flow type(technopolymer impeller on request)
<b>MECHANICAL SEAL</b>	Ceramic and graphite

#### MOTOR:

The pumps are coupled directly to an asynchronous, high efficiency SILVER ELEPHANT induction motor of suitable size, which is quiet running, close and extremely ventilated, suitable for continuous duty.

**The thermal cutout relay (motor protector) is incorporated in single phase motors.**

Three phase motors require an adequate external motor protector, with connections according to current standards.

**INSULATION** Class B

**PROTECTION** IP44

**CONSTRUCTION AND SAFETY STANDARDS** in compliance with IEC.

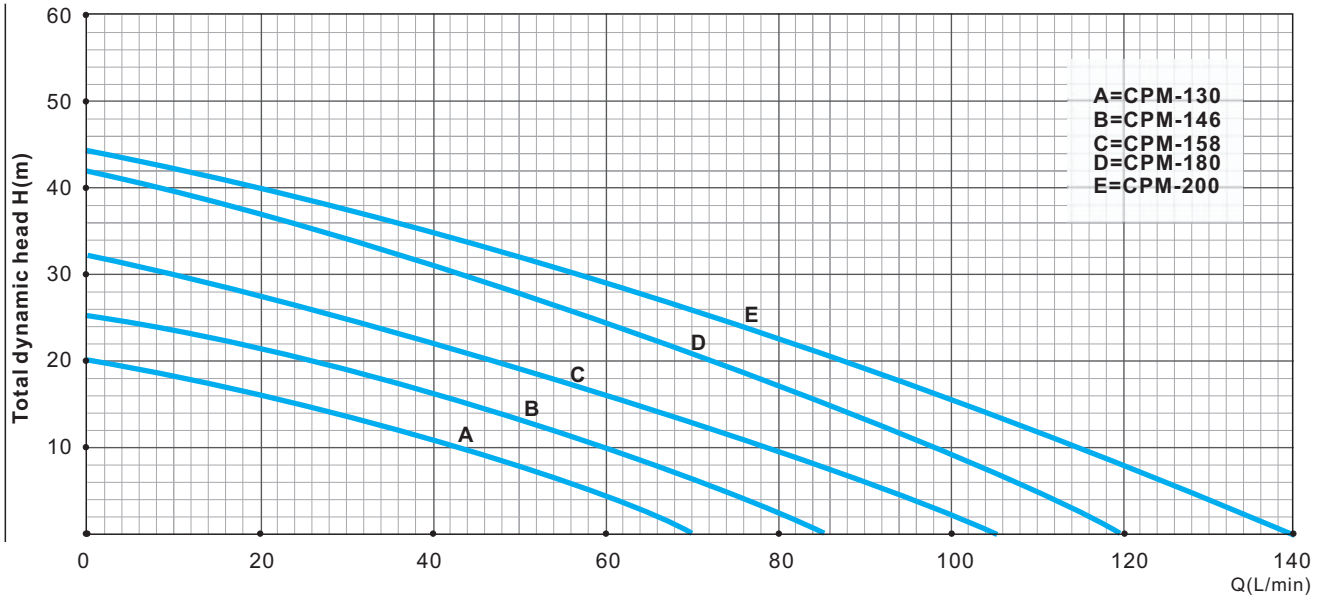

**TECHNICAL DATA**

Type	Power		Ampere 1~220V	R.P.M	Q.Max (l/min)	H.Max (m)	S.Head (M)	Pipe Dia	L×W×H (mm)	N.W (Kg)
	HP	kW								
CPM-130	0.5	0.37	2.7	2850	70	20	8	1"X1"	310X170X230	9.5
CPM-146	0.75	0.55	3.6	2850	85	25	8	1"X1"	340X175X235	12.6
CPM-158	1	0.75	5	2850	105	32	8	1"X1"	340X210X250	14.7
CPM-180	1.5	1.1	7.5	2850	120	42	8	1"X1"	425X250X320	23
CPM-200	2	1.5	9.6	2850	140	44	8	1"X1"	425X250X320	26

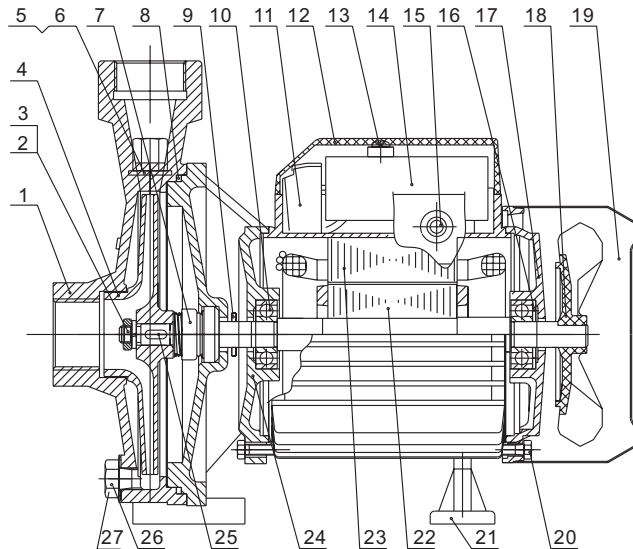

**MATERIAL DATA**

Item	Description.	Material	Item	Description.	Material	Item	Description.	Material	Item	Description.	Material	Item	Description.	Material
1	Pump Body	C.I.HT200	7	M. Seal	SS304&NBR...	13	Screw	Steel-A3	19	Fan cover	A3	25	Key	SS420
2	Key	SS420	8	O ring	NBR	14	Capacitor	CBB60	20	Screw	Steel-A3	26	Drain plug	H59
3	Snap ring	SS420	9	Drops guard	NBR	15	Fairlead	NBR	21	Bottom foot		27	Washer	NBR
4	Impeller	Brass or Noryl	10	Bearing		16	Spring ring	65Mn	22	Rotor				
5	Priming plug	Brass H59	11	Terminal Block	ABS	17	End cover	AL-ZL102	23	Stator				
6	Washer	NBR	12	Terminal Cover	ABS	18	Fan	ABS	24	Front cover	C.I.-HT200			