



AUDP SERIES
 CE TÜV

DEEP WELL AUTOMATIC PUMPS

AUDP SERIES

INSTALLATION AND APPLICATIONS

These pumps are suitable for suction from deep wells, and the series installed above ground with the get body submerged guarantees functioning even when the static level of the well water falls as far as of meters below the level of the installed pump. For this reason these pumps are extremely reliable, economical and simple to use and find many use in domestic where the suction depth exceed the normal capacity(9 meters)for surface pumps.

OPERATING LIMITS

Suction lift up to 45 m
 Maximum ambient temperature +40°C

PERFORMANCE RANGE

Flow rate up to 56 l/min (3.4 m³/h)
 Dynamic head up to 80m

WARRANTY: 1 YEARS

(according to our general sales conditions).

STRUCTURAL CHARACTERISTICS

PUMP BODY	Cast iron
FRONT COVER	Cast iron
IMPELLER	Brass , centrifugal radial flow type(technopolymer impeller on request)
MECHANICAL SEAL	Ceramic and graphite

MOTOR:

The pumps are coupled directly to an asynchronous, high efficiency SILVER ELEPHANT induction motor of suitable size, which is quiet running, close and extremely ventilated, suitable for continuous duty.

The thermal cutout relay (motor protector) is incorporated in single phase motors.

Three phase motors require an adequate external motor protector, with connections according to current standards.

INSULATION	Class B
PROTECTION	IP44

CONSTRUCTION AND SAFETY STANDARDS in compliance with IEC.



TECHNICAL DATA

Model	Power		Total head M	Ampere 1~220V	Pipe Dia	Ejector Type	Suct.Depth m	Capacity l/min-At discharge head m					L×W×H mm	GW KGs
	HP	kW						10m	15m	25m	35m	45m		
AUDP195A	0.5	0.37	40	2.1	1.25"X1"X1"	E20	10	40	34	12			420×295×230	15.8
						E20	15	34	20	5				
						E30	20	17	13	7				
AUDP255A	0.75	0.55	50	3.5	1.25"X1"X1"	E20	15		38	24	15	420×295×230	17.4	
						E30	20		30	17	10			
						E30	30		21	12	7			
AUDP370A	1	0.75	55	4.6	1.25"X1"X1"	E20	15		45	38	23	420×295×230	18.4	
						E30	20		38	28	12			
						E30	30		29	22	8			
AUDP505A	1.5	1.1	80	6.4	1.25"X1"X1"	E20	15		56	48	35	25	520×235×285	32.0
						E20	25		50	41	28	17		
						E30	35		26	20	15	10		
						E30	45		16	12	10	7		

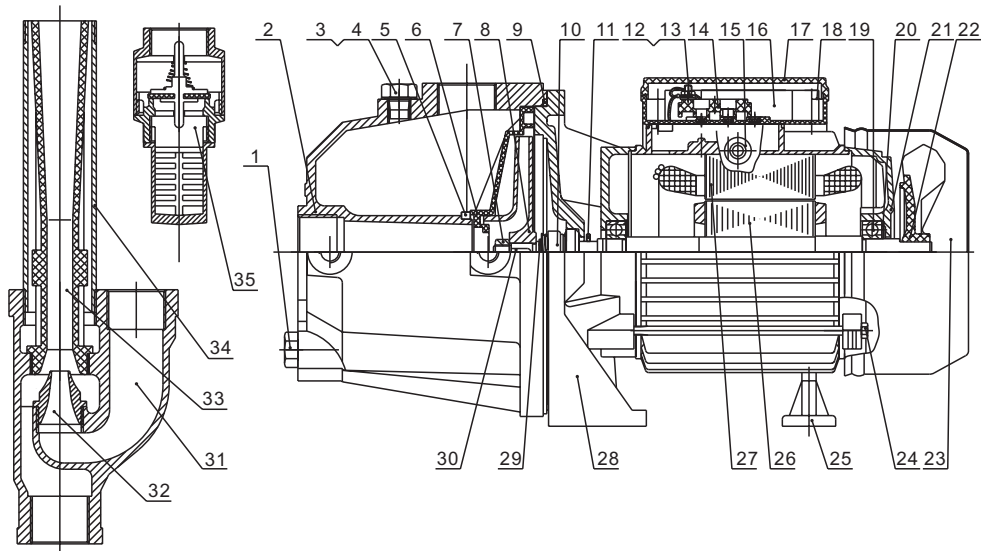

MATERIAL DATA

Item	Description.	Material	Item	Description.	Material	Item	Description.	Material	Item	Description.	Material	Item	Description.	Material
1	Screw G1/4	Brass H59	8	Impeller	Brass H59	15	Fairlead	NBR	22	Fan	ABS	29	Snap ring	65Mn
2	Pump body	HT200	9	O ring	NBR	16	Capacitor		23	Fan cover	A3	30	Key	SS420
3	Priming Plug	Brass H59	10	M. Seal		17	Terminal cover	ABS	24	Screw M5	A3	31	Ejector	HT200
4	Washer	NBR	11	Drops guard	NBR	18	Screw	A3	25	Bottom foot		32	Nozzle	Brass H59
5	O ring	NBR	12	Washer	T2	19	Bearing		26	Rotor		33	Venturi tube	ABS
6	Diffuser	ABS	13	Nut	H59	20	Spring ring		27	Stator		34	Pipe	Brass H59
7	Nut	A3	14	Terminal block		21	End cover	Ht200	28	Front cover	Ht200	35	Check Valve	Brass H59